

1. THIS APPLIANCE IS INTENDED FOR PERMANENT CONNECTION TO THE MAINS ELECTRICAL SUPPLY BY A SUITABLY QUALIFIED PERSON.
2. THIS APPLIANCE MUST BE SITED AND CONNECTED IN ACCORDANCE WITH CURRENT UK BUILDING AND WIRING REGULATIONS (BS7671) OR THE APPROPRIATE NATIONAL REGULATIONS AND STANDARDS IN YOUR COUNTRY.
3. WIRING TO THE APPLIANCE IN THE UK MUST BE VIA A FUSED AND SWITCHED CONNECTION UNIT INCORPORATING A DOUBLE POLE SWITCH WITH 3mm CONTACT SEPARATION AND CONFORMING TO BS5733 OR BS1363 PART 4. A 3 AMP BS1362 FUSE SHOULD BE FITTED TO THE CONNECTION UNIT WHICH MUST BE LOCATED OUTSIDE OF A ROOM CONTAINING A FIXED BATH OR SHOWER.
4. WARNING: THIS APPLIANCE IS CLASS I AND IT MUST THEREFORE BE EARTHED.
5. CHECK THE RATING PLATE ON THE APPLIANCE TO ENSURE THAT THE ELECTRICAL SUPPLY IS COMPATIBLE WITH THE APPLIANCE WHICH IS RATED AT 220-240V 50HZ AC.

IMPORTANT POINTS TO NOTE

1. THE OVERALL ELECTRICAL POWER CONSUMPTION OF THE UNIT IS 35 WATTS AT HIGH SPEED AND 15 WATTS AT LOW SPEED.
2. THE UNIT'S MOTOR IS FITTED WITH STANDARD THERMAL OVERLOAD PROTECTION, WHICH IN THE EVENT OF A FAULT CAUSING THE MOTOR TO OVERHEAT WILL CUT OFF THE ELECTRICAL SUPPLY TO THE MOTOR.
3. THE FAN UNIT MAY BE CONNECTED THROUGH A VENT-AXIA RESPONSE HUMIDISTAT (STOCK REF. 563550), WHICH AUTOMATICALLY SWITCHES THE FAN UNIT FROM TRICKLE TO BOOST VENTILATION WHEN THE RELATIVE HUMIDITY IN THE ROOM EXCEEDS A PRE-SET ADJUSTABLE LEVEL.
4. THE UNIT INCORPORATES ELECTRICAL CONNECTIONS FOR OPERATING AT TWO SPEEDS, THEREBY PROVIDING TRICKLE AND/OR BOOST VENTILATION OPTIONS (SEE FIG. 5).
5. THE OVERALL ELECTRICAL POWER CONSUMPTION OF THE UNIT IS 35 WATTS AT HIGH SPEED AND 15 WATTS AT LOW SPEED.
6. THE UNIT'S MOTOR IS FITTED WITH STANDARD THERMAL OVERLOAD PROTECTION, WHICH IN THE EVENT OF A FAULT CAUSING THE MOTOR TO OVERHEAT WILL CUT OFF THE ELECTRICAL SUPPLY TO THE MOTOR.
7. THE FAN UNIT MAY BE CONNECTED THROUGH A VENT-AXIA RESPONSE HUMIDISTAT (STOCK REF. 563550), WHICH AUTOMATICALLY SWITCHES THE FAN UNIT FROM TRICKLE TO BOOST VENTILATION WHEN THE RELATIVE HUMIDITY IN THE ROOM EXCEEDS A PRE-SET ADJUSTABLE LEVEL.
8. THE APPLIANCE IS NOT SUITABLE FOR INSTALLATION IN A SHOWER CUBICLE OR EN-CLOSURE AND MUST BE SITED AWAY FROM ANY SOURCE OF WATER SPRAY.
9. THIS APPLIANCE MUST BE SITED OUT OF REACH OF A PERSON USING A FIXED BATH OR SHOWER.
10. THE APPLIANCE MUST BE SITED AWAY FROM DIRECT SOURCES OF HEAT IN EXCESS OF 40°C.
11. IF THE APPLIANCE IS INSTALLED IN A ROOM CONTAINING A FUEL BURNING APPLIANCE, THE INSTALLER MUST ENSURE THAT AIR RE-PLACEMENT IS ADEQUATE FOR BOTH APPLIANCES.
12. THE EXTERNAL GRILLE OF THE APPLIANCE MUST BE SITED AT LEAST 600mm AWAY FROM THE FLUE OF A FUEL BURNING APPLIANCE.
13. DO NOT SITE THE FAN UNIT IN THE VICINITY OF EXCESSIVE LEVELS OF AIRBORNE OIL OR GREASE.
14. DO NOT CONNECT A LAMP ACROSS THE SUPPLY TO THE APPLIANCE. FAULTY OPERATION OF THE LAMP WILL OCCUR AND THE APPLIANCE WILL FAIL.
15. ALL SAFETY REGULATIONS AND REQUIREMENTS MUST BE STRICTLY FOLLOWED TO PREVENT HAZARDS TO LIFE AND PROPERTY BOTH DURING AND AFTER INSTALLATION AND DURING ANY SUBSEQUENT MAINTENANCE OR SERVICING.
16. ENSURE THE MAINS ELECTRICAL SUPPLY IS SWITCHED OFF BEFORE COMMENCING INSTALLATION, MAINTENANCE OR SERVICING.

CABLE RUNS

1. Decide where to site the ventilation unit and work out the cable runs. When using surface wiring which is not contained in conduit, the wiring must be securely anchored to the mounting surface.
2. Install the cable runs in conjunction with a Fused and Switched Connection Unit located in the vicinity of where the ventilation unit will be sited. Ensure that the cables for the ventilation unit extend at least 400mm from the mounting surface.

1. Remove the duct, grille assembly and heat recovery ventilation unit from the packaging.
2. After noting the positions of the duct spigot and optional cable entry grommets on the top and rear of the housing (see Fig. 1), cut a 14mm diameter hole through the wall.
3. Cut the duct to a length which will provide for a flush finish with the internal and external wall faces. DO NOT CUT THE END OF THE DUCT WHICH IS SLOTTED TO ACCEPT THE EXTERNAL GRILLE.
4. With the web in the duct vertical, the slotted end of the duct to the outside and the duct sloping slightly downwards to the inside for drainage of condensation, place the duct in the wall by applying suitable gap filler between the duct and hole. The filler must create a flush finish at the outer wall face to allow the external grille to be fixed satisfactorily. At the inner wall face the filter must be recessed at least 20mm to allow the duct to clear the cable.
5. For top cable entry make a cutout in the top of the cover to clear the cable.
6. Refit the cover and tighten the four retaining screws.
7. Switch on the mains electrical supply and check the fan operation.
8. Remove the cover from the unit after removing the two retaining screws in the side and slackening the two retaining screws in the bottom of the cover.
9. Remove the filter from inside the cover.
10. Withdraw the heat exchanger from the housing by grasping and gently pulling on its central vertical member.
11. Pass the supply cable through the grommet in the rear face or top face of the housing and fix the housing to the inner mounting surface using suitable round head woodscrews.
12. Fix the grille base to the external wall surface also using suitable round head woodscrews.
13. Replace the insect screen and grille in the grille base. The grille blades must slope downwards away from the external mounting surface to shed rainwater.
14. Offer the grille base to the external mounting surface and, with the duct spigot located inside the duct, mark the insect screen.
15. Offer the grille base to the external mounting surface and, with the duct spigot located over the duct, mark the two fixing hole positions on the mounting surface.
16. Fix the grille out of the grille assembly and remove the insect screen.
17. Offer the housing to the inner mounting surface and, with the duct spigot located over the duct, mark the two fixing hole positions on the mounting surface.
18. Withdraw the heat exchanger from the housing by grasping and gently pulling on its central vertical member.
19. Offer the housing to the inner mounting surface and, with the duct spigot located over the duct, mark the two fixing hole positions on the mounting surface.
20. Fix the grille out of the grille assembly and remove the insect screen.
21. Offer the grille base to the external mounting surface and, with the duct spigot located inside the duct, mark the insect screen.
22. Offer the grille base to the external mounting surface and, with the duct spigot located over the duct, mark the two fixing hole positions on the mounting surface.
23. Withdraw the heat exchanger from the housing by grasping and gently pulling on its central vertical member.
24. Offer the housing to the inner mounting surface and, with the duct spigot located over the duct, mark the two fixing hole positions on the mounting surface.
25. Fix the grille out of the grille assembly and remove the insect screen.
26. Offer the grille base to the external mounting surface and, with the duct spigot located inside the duct, mark the insect screen.
27. Offer the grille base to the external mounting surface and, with the duct spigot located over the duct, mark the two fixing hole positions on the mounting surface.
28. Withdraw the heat exchanger from the housing by grasping and gently pulling on its central vertical member.
29. Offer the housing to the inner mounting surface and, with the duct spigot located over the duct, mark the two fixing hole positions on the mounting surface.
30. Fix the grille out of the grille assembly and remove the insect screen.
31. Offer the grille base to the external mounting surface and, with the duct spigot located inside the duct, mark the insect screen.
32. Offer the grille base to the external mounting surface and, with the duct spigot located over the duct, mark the two fixing hole positions on the mounting surface.
33. Withdraw the heat exchanger from the housing by grasping and gently pulling on its central vertical member.
34. Offer the housing to the inner mounting surface and, with the duct spigot located over the duct, mark the two fixing hole positions on the mounting surface.
35. Fix the grille out of the grille assembly and remove the insect screen.
36. Offer the grille base to the external mounting surface and, with the duct spigot located inside the duct, mark the insect screen.
37. Offer the grille base to the external mounting surface and, with the duct spigot located over the duct, mark the two fixing hole positions on the mounting surface.
38. Withdraw the heat exchanger from the housing by grasping and gently pulling on its central vertical member.
39. Offer the housing to the inner mounting surface and, with the duct spigot located over the duct, mark the two fixing hole positions on the mounting surface.
40. Fix the grille out of the grille assembly and remove the insect screen.
41. Offer the grille base to the external mounting surface and, with the duct spigot located inside the duct, mark the insect screen.
42. Offer the grille base to the external mounting surface and, with the duct spigot located over the duct, mark the two fixing hole positions on the mounting surface.
43. Withdraw the heat exchanger from the housing by grasping and gently pulling on its central vertical member.
44. Offer the housing to the inner mounting surface and, with the duct spigot located over the duct, mark the two fixing hole positions on the mounting surface.
45. Fix the grille out of the grille assembly and remove the insect screen.
46. Offer the grille base to the external mounting surface and, with the duct spigot located inside the duct, mark the insect screen.
47. Offer the grille base to the external mounting surface and, with the duct spigot located over the duct, mark the two fixing hole positions on the mounting surface.
48. Withdraw the heat exchanger from the housing by grasping and gently pulling on its central vertical member.
49. Offer the housing to the inner mounting surface and, with the duct spigot located over the duct, mark the two fixing hole positions on the mounting surface.
50. Fix the grille out of the grille assembly and remove the insect screen.
51. Offer the grille base to the external mounting surface and, with the duct spigot located inside the duct, mark the insect screen.
52. Offer the grille base to the external mounting surface and, with the duct spigot located over the duct, mark the two fixing hole positions on the mounting surface.
53. Withdraw the heat exchanger from the housing by grasping and gently pulling on its central vertical member.
54. Offer the housing to the inner mounting surface and, with the duct spigot located over the duct, mark the two fixing hole positions on the mounting surface.
55. Fix the grille out of the grille assembly and remove the insect screen.
56. Offer the grille base to the external mounting surface and, with the duct spigot located inside the duct, mark the insect screen.
57. Offer the grille base to the external mounting surface and, with the duct spigot located over the duct, mark the two fixing hole positions on the mounting surface.
58. Withdraw the heat exchanger from the housing by grasping and gently pulling on its central vertical member.
59. Offer the housing to the inner mounting surface and, with the duct spigot located over the duct, mark the two fixing hole positions on the mounting surface.
60. Fix the grille out of the grille assembly and remove the insect screen.
61. Offer the grille base to the external mounting surface and, with the duct spigot located inside the duct, mark the insect screen.
62. Offer the grille base to the external mounting surface and, with the duct spigot located over the duct, mark the two fixing hole positions on the mounting surface.
63. Withdraw the heat exchanger from the housing by grasping and gently pulling on its central vertical member.
64. Offer the housing to the inner mounting surface and, with the duct spigot located over the duct, mark the two fixing hole positions on the mounting surface.
65. Fix the grille out of the grille assembly and remove the insect screen.
66. Offer the grille base to the external mounting surface and, with the duct spigot located inside the duct, mark the insect screen.
67. Offer the grille base to the external mounting surface and, with the duct spigot located over the duct, mark the two fixing hole positions on the mounting surface.
68. Withdraw the heat exchanger from the housing by grasping and gently pulling on its central vertical member.
69. Offer the housing to the inner mounting surface and, with the duct spigot located over the duct, mark the two fixing hole positions on the mounting surface.
70. Fix the grille out of the grille assembly and remove the insect screen.
71. Offer the grille base to the external mounting surface and, with the duct spigot located inside the duct, mark the insect screen.
72. Offer the grille base to the external mounting surface and, with the duct spigot located over the duct, mark the two fixing hole positions on the mounting surface.
73. Withdraw the heat exchanger from the housing by grasping and gently pulling on its central vertical member.
74. Offer the housing to the inner mounting surface and, with the duct spigot located over the duct, mark the two fixing hole positions on the mounting surface.
75. Fix the grille out of the grille assembly and remove the insect screen.
76. Offer the grille base to the external mounting surface and, with the duct spigot located inside the duct, mark the insect screen.
77. Offer the grille base to the external mounting surface and, with the duct spigot located over the duct, mark the two fixing hole positions on the mounting surface.
78. Withdraw the heat exchanger from the housing by grasping and gently pulling on its central vertical member.
79. Offer the housing to the inner mounting surface and, with the duct spigot located over the duct, mark the two fixing hole positions on the mounting surface.
80. Fix the grille out of the grille assembly and remove the insect screen.
81. Offer the grille base to the external mounting surface and, with the duct spigot located inside the duct, mark the insect screen.
82. Offer the grille base to the external mounting surface and, with the duct spigot located over the duct, mark the two fixing hole positions on the mounting surface.
83. Withdraw the heat exchanger from the housing by grasping and gently pulling on its central vertical member.
84. Offer the housing to the inner mounting surface and, with the duct spigot located over the duct, mark the two fixing hole positions on the mounting surface.
85. Fix the grille out of the grille assembly and remove the insect screen.
86. Offer the grille base to the external mounting surface and, with the duct spigot located inside the duct, mark the insect screen.
87. Offer the grille base to the external mounting surface and, with the duct spigot located over the duct, mark the two fixing hole positions on the mounting surface.
88. Withdraw the heat exchanger from the housing by grasping and gently pulling on its central vertical member.
89. Offer the housing to the inner mounting surface and, with the duct spigot located over the duct, mark the two fixing hole positions on the mounting surface.
90. Fix the grille out of the grille assembly and remove the insect screen.
91. Offer the grille base to the external mounting surface and, with the duct spigot located inside the duct, mark the insect screen.
92. Offer the grille base to the external mounting surface and, with the duct spigot located over the duct, mark the two fixing hole positions on the mounting surface.
93. Withdraw the heat exchanger from the housing by grasping and gently pulling on its central vertical member.
94. Offer the housing to the inner mounting surface and, with the duct spigot located over the duct, mark the two fixing hole positions on the mounting surface.
95. Fix the grille out of the grille assembly and remove the insect screen.
96. Offer the grille base to the external mounting surface and, with the duct spigot located inside the duct, mark the insect screen.
97. Offer the grille base to the external mounting surface and, with the duct spigot located over the duct, mark the two fixing hole positions on the mounting surface.
98. Withdraw the heat exchanger from the housing by grasping and gently pulling on its central vertical member.
99. Offer the housing to the inner mounting surface and, with the duct spigot located over the duct, mark the two fixing hole positions on the mounting surface.
100. Fix the grille out of the grille assembly and remove the insect screen.

CLEANING

1. Remove the terminal block cover after unscrewing the retaining screw.
2. Remove the minimum amount of sheath and insulation from the supply cable and leads. Slacken the cable clamps and feed the cable through the clamps. Connect the conductors, colour-coded as follows: (L), black-neutral (N) and green/yellow-earth (E/≡), to the appropriate terminals, marked L1, L2, N and E/≡, of the terminal block in accordance with the wiring arrangements shown in Fig. 5.
3. With the web in the duct vertical, the slotted end of the duct to the outside and the duct sloping slightly downwards to the inside for drainage of condensation, place the duct in the wall by applying suitable gap filler between the duct and hole. The filler must create a flush finish at the outer wall face to allow the external grille to be fixed satisfactorily. At the inner wall face the filter must be recessed at least 20mm to allow the duct to clear the cable.
4. For top cable entry make a cutout in the top of the cover to clear the cable.
5. Refit the cover and tighten the four retaining screws.
6. Switch on the mains electrical supply and check the fan operation.

INSTALLATION AND MAINTENANCE INSTRUCTIONS

VENT-AXIA HR100S - HEAT RECOVERY FAN

VENT-AXIA SALES CENTRES

ENGLAND & WALES NATIONAL CALL CENTRE
Newton Road, Crawley
West Sussex
RH10 9JA

Telephone: 01293 530202
Fax: 01293 565169

NORTHERN IRELAND

Telephone: 02890 402220
Fax: 01293 565169

SCOTLAND

Telephone: 0141 429 1166
Fax: 01293 565169

REPUBLIC OF IRELAND
Vent-Axia Ventilation Ltd.
921 Western Industrial Estate
Naas Road, Dublin 12.

Telephone: (01) 450 4133
Fax: (01) 450 4570

Did you find these instructions easy to use?

We value your comments, contact us via:

email: info@vent-axia.com

The Vent-Axia Guarantee

- Applicable only to products installed and used in the United Kingdom. For details of guarantee outside the United Kingdom contact your local supplier.
- Vent-Axia guarantees its products for one year from the date of purchase against faulty material or workmanship. In the event of any part being found to be defective, the product will be repaired, or at the Company's option replaced, without charge, provided that the product:
 - 1) has been installed and used in accordance with the instructions given with each unit.
 - 2) has not been connected to an unsuitable electricity supply. (The correct electricity supply voltage is shown on the product rating label attached to the unit.)
 - 3) has not been subjected to misuse, neglect or damage.
 - 4) has not been modified or repaired by any person not authorised by the company.

IF CLAIMING UNDER TERMS OF GUARANTEE

- please return the complete product, carriage paid to your original supplier or nearest Vent-Axia Centre, by post or personal visit. Please ensure that it is adequately packed and accompanied by a letter clearly marked 'Guarantee Claim' stating the nature of the fault and providing evidence of date and source of purchase.
- The guarantee is offered to you as an extra benefit, and does not affect your legal rights.

As part of the policy of continuous product improvement Vent-Axia reserves the right to alter specifications without notice.

Vent-Axia®

Head Office: Fleming Way, Crawley, West Sussex RH10 2NN
Tel: 01293 526062 Fax: 01293 551188



Printed by Jet Printing, Crawley

Vent-Axia®

HR100S HEAT RECOVERY VENTILATION UNIT

Installation and Maintenance Instructions

Surface mounting two speed heat recovery extract and intake unit for bathrooms and toilets.

Stock Ref: 141 10 010

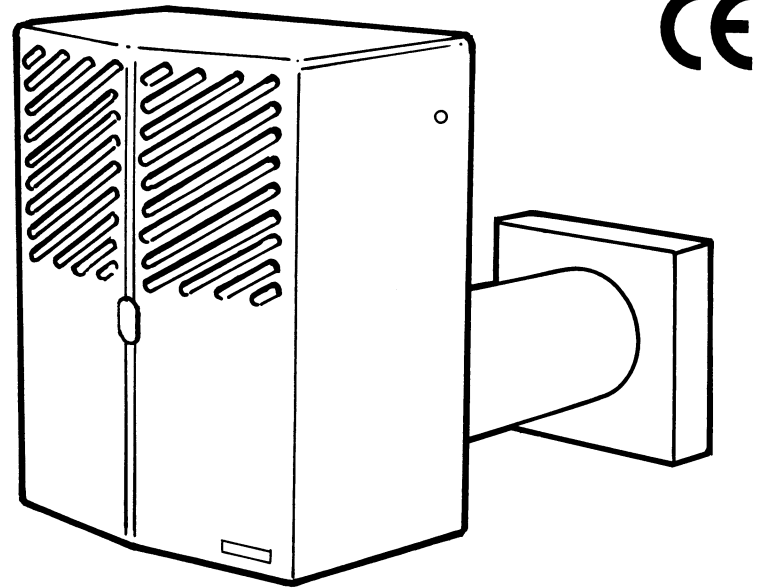

- ◆ Single room heat recovery unit
- ◆ Easy to install
- ◆ Energy saving
- ◆ Trickle and/or boost ventilation modes
- ◆ Extremely quiet trickle ventilation mode

220-240V/1/50Hz 35W

PLEASE LEAVE THESE INSTRUCTIONS WITH THE END USER

FIG. 1. DIMENSIONS

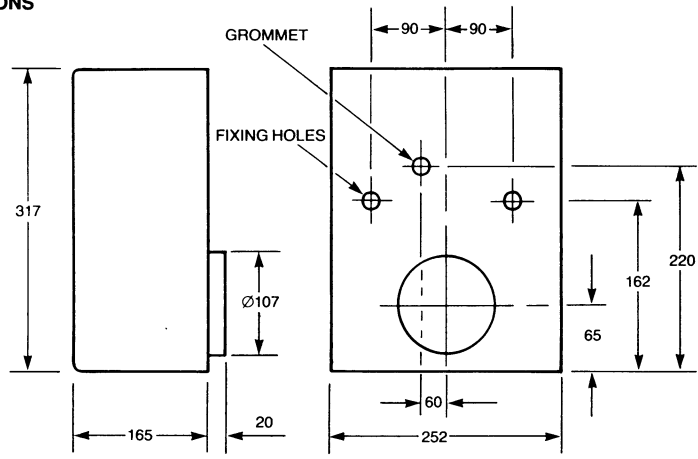

FIG. 2. WALL SECTION

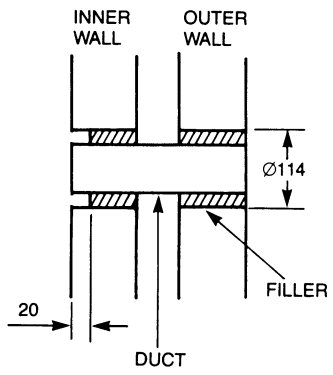

FIG. 3. AIRFLOW

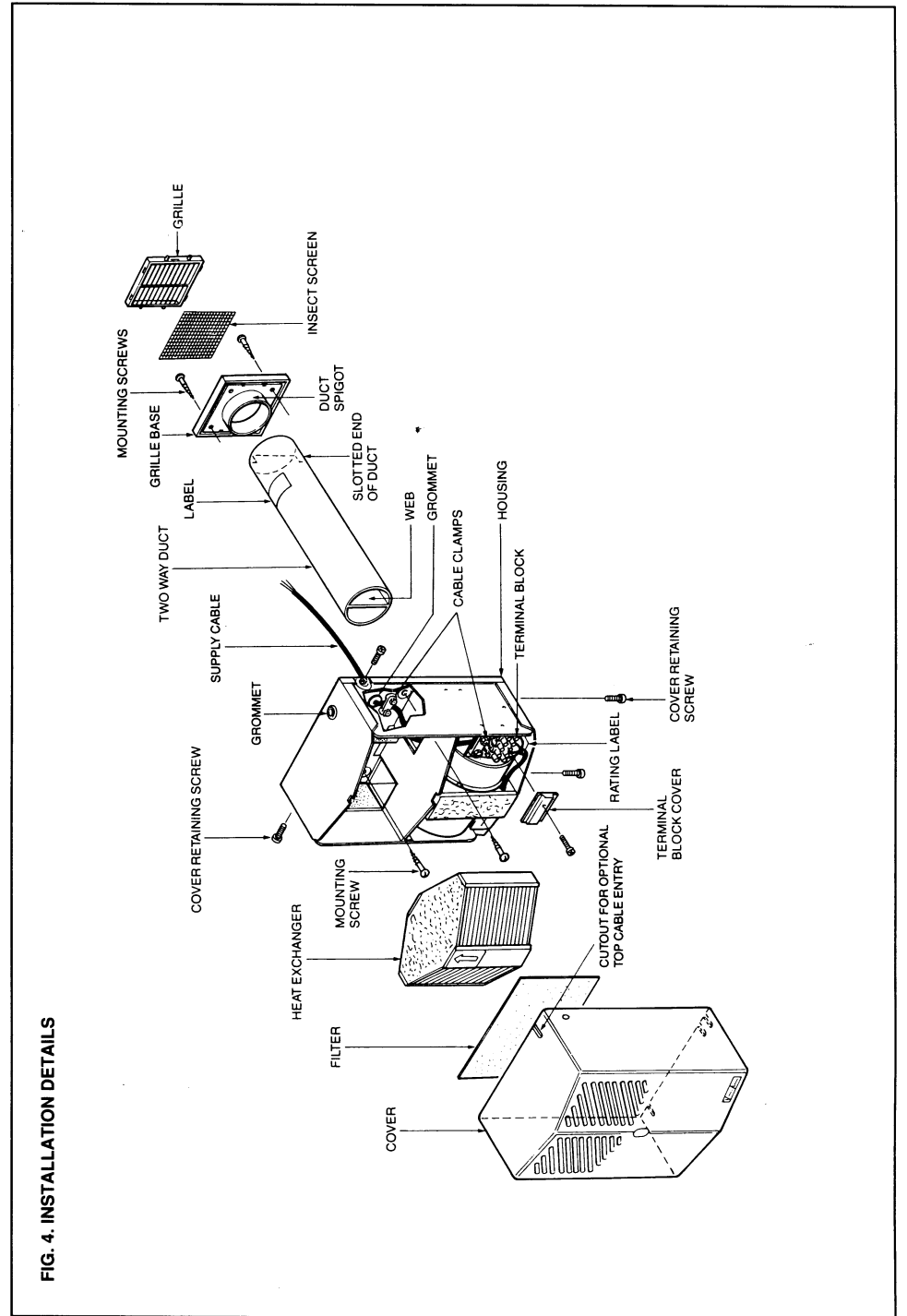
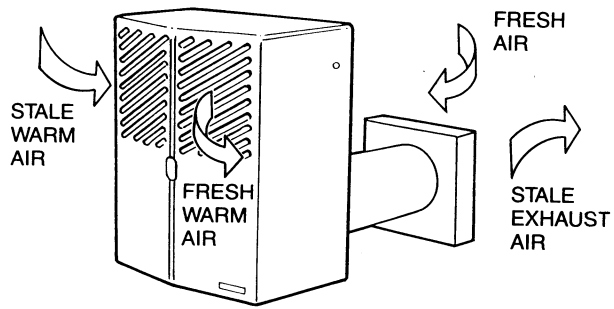
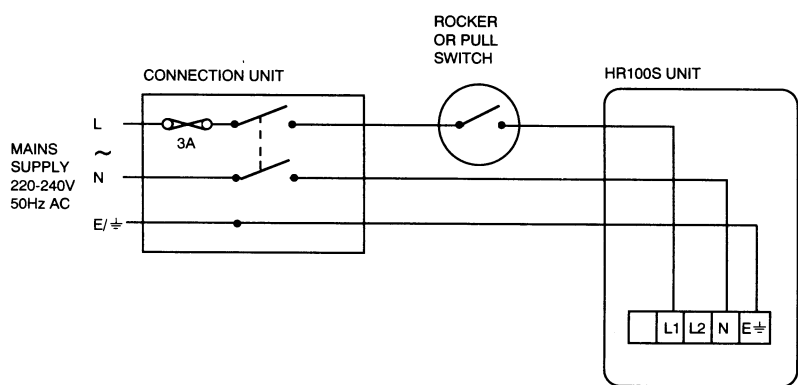

FIG. 4. INSTALLATION DETAILS

FIG. 5. WIRING DIAGRAMS

5.1. MANUALLY CONTROLLED TRICKLE VENTILATION



5.2. MANUALLY CONTROLLED BOOST VENTILATION

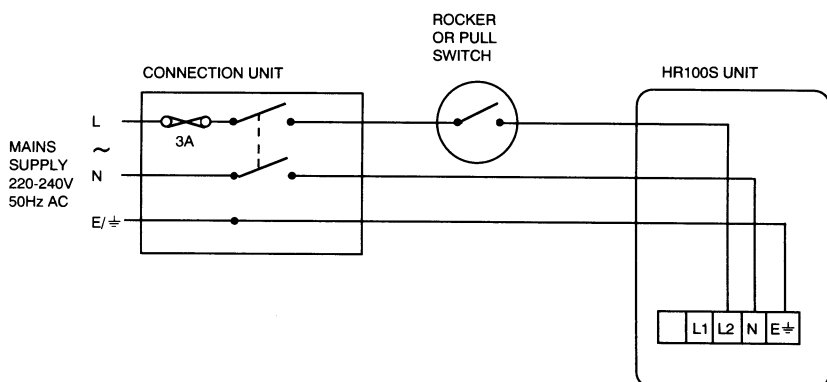

5.3 MANUALLY CONTROLLED CONTINUOUS TRICKLE OR BOOST VENTILATION

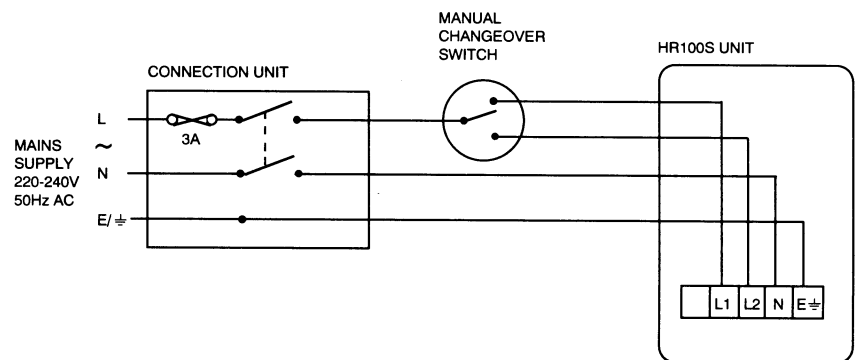

5.4 AUTOMATIC HUMIDITY CONTROLLED VENTILATION

Continuous trickle ventilation switched to boost ventilation when the room relative humidity (RH) exceeds a preset adjustable level.

